

**BALDOR® • RELIANCE®**

---

# Customer information packet 111

20C 2P BUFFER

**Part detail**

|                     |            |
|---------------------|------------|
| <b>Revision</b>     | K          |
| <b>Type</b>         | AC         |
| <b>Mech. spec.</b>  | G7-0429    |
| <b>Base</b>         |            |
| <b>Status</b>       | PRD/A      |
| <b>Elec. spec.</b>  | G7WG0030   |
| <b>Layout</b>       | G7LY0429   |
| <b>Eff. date</b>    | 09-23-2022 |
| <b>CD Diagram</b>   | CD0279     |
| <b>Poles</b>        | 02         |
| <b>Leads</b>        | 4#18       |
| <b>Proprietary</b>  | False      |
| <b>Created date</b> | 08-06-2018 |

**Nameplate**

| NP3352L        |                |              |      |
|----------------|----------------|--------------|------|
| <b>CAT.NO.</b> | 111            |              |      |
| <b>HP</b>      | .33            | <b>VOLTS</b> | 115  |
| <b>PHASE</b>   | 1              | <b>AMPS</b>  | 4.2  |
| <b>HZ</b>      | 60             | <b>RPM</b>   | 3600 |
| <b>SER.NO</b>  |                |              |      |
| <b>SPEC.</b>   | G7-0429-0030G1 |              |      |
| <b>BLANK</b>   |                |              |      |

## Parts list

| Part number | Description                               | Quantity |
|-------------|---|----------|
| SA359418    | SA G7-0429-0030G1                         | 1.000 ea |
| RA348508    | RA G7-0429-0030G1                         | 1.000 ea |
| OC3006F12   | CYL OIL CAP 6MFD/370V                     | 1.000 ea |
| G7BA3000    | G7-286 BASE DIE CAST                      | 1.000 ea |
| WD4102A01   | SR-6L-1 HEYCO STRN RELIEF OR 23MPO6L10 M  | 1.000 ea |
| WD1000A16   | 2-520128-2 AMP FLAG TERMINAL(4M/RL)       | 4.000 ea |
| 11XW1032G06 | 10-32 X .38, TAPTITE II, HEX WSHR SLTD U  | 1.000 ea |
| HW3001B02   | BRASS CUP WASHER W/GROUND SYMBOL TAB,     | 1.000 ea |
| SP9000SP    | 80600BJ A-H OR 1520237-2 TYCO;2PST,125/2  | 1.000 ea |
| HW1003A50   | LOCKWASHER,1/2",EXT.TOOTHZINC PLATED      | 1.000 ea |
| G7CB4500    | BASE COVER PLATE 7" GRINDER               | 1.000 ea |
| 51XW1032A06 | 10-32 X .38, TAPTITE II, HEX WSHR SLTD S  | 2.000 ea |
| RM1005A01SP | BUMPER- #2089 (R-R CO)                    | 4.000 ea |
| G7EP3900A04 | ENDPLATE, MACH                            | 1.000 ea |
| HW5100A03   | WAVY WASHER (W1543-017)                   | 2.000 ea |
| G7EP3900A04 | ENDPLATE, MACH                            | 1.000 ea |
| XY1032A02   | 10-32 HEX NUT DIRECTIONAL SERRATION       | 4.000 ea |
| HA6050A02SP | FLANGE, WHEEL, MACH                       | 2.000 ea |
| HA6050A02SP | FLANGE, WHEEL, MACH                       | 2.000 ea |
| HW3021C04   | SPRG PIN 3/32 DIA .375LGH DRIV-LOK        | 1.000 ea |
| HW3021C04   | SPRG PIN 3/32 DIA .375LGH DRIV-LOK        | 1.000 ea |
| XY5020A12SP | 1/2-20 NUT R.H. HEX (NF)                  | 1.000 ea |
| XY5020A62SP | 1/2-20 NUT L.H. HEX (NF)X                 | 1.000 ea |
| RM1010A17   | VINYL CAP .812-16 701-89 BLACK            | 1.000 ea |
| 51XN1032A07 | 10-32 X 0.438 HX WS SL SR ZN              | 2.000 ea |
| RM1010A17   | VINYL CAP .812-16 701-89 BLACK            | 1.000 ea |
| XY1032A02   | 10-32 HEX NUT DIRECTIONAL SERRATION       | 2.000 ea |
| HA3100A29   | THRUBOLT 10-32 X 7.00                     | 4.000 ea |
| HA3205A50   | U550-N SWITCH NUT/CARLING                 | 1.000 ea |
| LD5001A11   | 6' cord w/115V plug 18-3 105C 300V B W G  | 1.000 ea |
| WD4006C05   | ORANGE, WIRENUT, G-B #13-003 ORG SIZE 73B | 2.000 ea |

|             |  |          |
|-------------|--|----------|
| HA6053A01ZP | CLAMP, CAPACITOR 2" DIA, WHITE ZINC PLAT | 1.000 ea |
| MG1000G01   | MUNSELL 5.93PB 3.81/ 2.71                | 0.014 ga |
| 85XU0407S04 | 4X1/4 U DRIVE PIN STAINLESS              | 2.000 ea |
| LB1009N     | LABEL,ROTATION DIRECTION (ON ROLLS)      | 1.000 ea |
| LB1091      | LABEL, WARNING BUFFERS                   | 1.000 ea |
| MN906       | Baldor Buffer 6/13                       | 1.000 ea |
| LB1119N     | WARNING LABEL                            | 1.000 ea |
| LC0279A01   | 1PH, DV, FIX, GRINDER, CONN FOR LV       | 1.000 ea |
| NP3352L     | ALUM NAMEPLATE - BALDOR BUFFER NO LOGOS  | 1.000 ea |
| G7PA1014    | PKG GRP, BLANK PK1034                    | 1.000 ea |
| LB1618      | PROPOSITION 65 WARNING LABEL 1-1/2 X 1/2 | 1.000 ea |

**Accessories**

| <b>Part number</b> | <b>Description</b>                      | <b>Multiplier</b> |
|--------------------|---|-------------------|
| GA16E              | PEDESTAL LIGHT INDUSTRIAL,STEEL         | A8                |
| GA16               | PEDESTAL INDUSTRIAL, CAST IRON 6" - 10" | A8                |
| GA14               | PEDESTAL FABRICATED STEEL W/SHELVES     | A8                |
| A65                | 6" COTTON BUFFING WHEEL 1/2" BORE       | A8                |
| BQ1-015-CC         | 1PH Brake, NEMA 1,110-125 VAC, 50/60Hz  | P1                |
| BQ1-015-CP         | 1PH Brake, Panel 110-125 VAC, 50/60 Hz  |                   |

G7LY0429

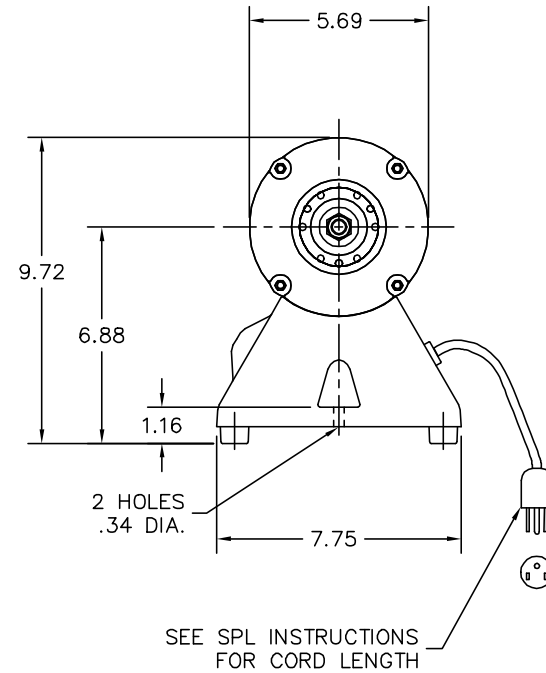
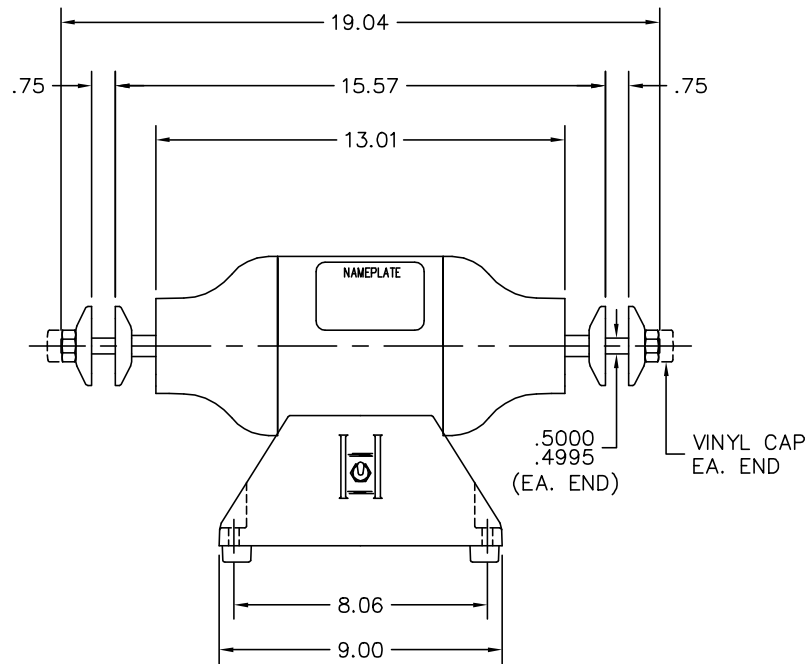

CUSTOMER IS RESPONSIBLE FOR DETERMINING THAT BALDOR'S PRODUCT WILL PERFORM SUITABLY IN THE INTENDED APPLICATION.

|                      |                              |                   |
|----------------------|------------------------------|-------------------|
| REV. DESC: NEW       |                              |                   |
| REV. LTR: -          | VERSION: 00                  | TDR: 000001079698 |
| FILE: \AAA\00244\395 | REVISED: 04:31:41 08/06/2018 | BY: ENMARHO       |
| MTL: -               | © □                          |                   |

**BALDOR - RELIANCE®**

BUFFER 7" TYPE "C" -115V W/SHAFT EXT FROM G6-209 (.50 DIA)

SH 1 of 1

G7LY0429

