

**BALDOR® • RELIANCE** 

**Product Information Packet**

**M2531T-8**

**25HP, 1760RPM, 3PH, 60HZ, 284T, 3942M, OPSB, F1**

Part Detail							
Revision:	G	Status:	INA/A	Change #:		Proprietary:	No
Type:	AC	Elec. Spec:	39WGX712	CD Diagram:	CD0695	Mfg Plant:	
Mech. Spec:	39L31	Layout:	39LYL031	Poles:	04	Created Date:	05-10-2010
Base:	RG	Eff. Date:	03-08-2016	Leads:	6#6		

Specs			
Catalog Number:	M2531T-8	KVA Code:	G
Enclosure:	ODP	Lifting Lugs:	Standard Lifting Lugs
Frame:	284T	Locked Bearing Indicator:	No Locked Bearing
Output @ Frequency:	25.000 HP @ 60 HZ	Motor Lead Quantity/Wire Size:	6 @ 6 AWG
Synchronous Speed @ Frequency:	1800 RPM @ 60 HZ	Motor Lead Exit:	Ko Box
Voltage @ Frequency:	200.0 V @ 60 HZ	Motor Lead Termination:	Flying Leads
XP Division:	Not Applicable	Motor Type:	3942M
Agency Approvals:	CSA	Mounting Arrangement:	F1
	UR	Power Factor:	83
Auxillary Box:	No Auxillary Box	Product Family:	General Purpose
Auxillary Box Lead Termination:	None	Pulley End Bearing Type:	Ball
Base Indicator:	RG	Pulley Face Code:	Standard
Bearing Grease Type:	Polyrex EM (-20F +300F)	Pulley Shaft Indicator:	Standard
Blower:	None	Rodent Screen:	None
Current @ Voltage:	70.000 A @ 200.0 V	Shaft Extension Location:	Pulley End
Design Code:	B	Shaft Ground Indicator:	No Shaft Grounding
Drip Cover:	No Drip Cover	Shaft Rotation:	Reversible
Duty Rating:	CONT	Shaft Slinger Indicator:	No Slinger

<b>Electrically Isolated Bearing:</b>	Not Electrically Isolated	<b>Speed Code:</b>	Single Speed
<b>Feedback Device:</b>	NO FEEDBACK	<b>Motor Standards:</b>	NEMA
<b>Front Face Code:</b>	Standard	<b>Starting Method:</b>	Part Winding
<b>Front Shaft Indicator:</b>	None	<b>Thermal Device - Bearing:</b>	None
<b>Heater Indicator:</b>	No Heater	<b>Thermal Device - Winding:</b>	None
<b>Insulation Class:</b>	B	<b>Vibration Sensor Indicator:</b>	No Vibration Sensor
<b>Inverter Code:</b>	Not Inverter	<b>Winding Thermal 1:</b>	None
		<b>Winding Thermal 2:</b>	None

Nameplate NP1256L										
CAT.NO.	M2531T-8									
SPEC.	39L031X712H2									
HP	25									
VOLTS	200									
AMP	70									
RPM	1760									
FRAME	284T				HZ	60			PH	3
SER.F.	1.15		CODE	G	DES	B		CLASS	B	
NEMA-NOM-EFF	91.7		PF	83						
RATING	40C AMB-CONT									
CC	010A				USABLE AT 208V					
DE	6311				ODE	6208				
ENCL	OPSB		SN							

**AC Induction Motor Performance Data**

Record # 31169

Typical performance - not guaranteed values

<b>Winding:</b> 39WGX712-R001		<b>Type:</b> 3942M		<b>Enclosure:</b> OPSB	
<b>Nameplate Data</b>			<b>200 V, 60 Hz: Single Voltage Motor</b>		
<b>Rated Output (HP)</b>	25	<b>Full Load Torque</b>	74 LB-FT		
<b>Volts</b>	200	<b>Start Configuration</b>	direct on line		
<b>Full Load Amps</b>	70	<b>Breakdown Torque</b>	211 LB-FT		
<b>R.P.M.</b>	1760	<b>Pull-up Torque</b>	104 LB-FT		
<b>Hz</b>	60 <b>Phase</b>	3	<b>Locked-rotor Torque</b>	119 LB-FT	
<b>NEMA Design Code</b>	B <b>KVA Code</b>	G	<b>Starting Current</b>	421 A	
<b>Service Factor (S.F.)</b>	1.15	<b>No-load Current</b>	26 A		
<b>NEMA Nom. Eff.</b>	91.7 <b>Power Factor</b>	83	<b>Line-line Res. @ 25°C</b>	0.0748 Ω	
<b>Rating - Duty</b>	40C AMB-CONT		<b>Temp. Rise @ Rated Load</b>	42°C	
<b>S.F. Amps</b>			<b>Temp. Rise @ S.F. Load</b>	51°C	
			<b>Locked-rotor Power Factor</b>	34	
			<b>Rotor inertia</b>	1.84 LB-FT <sup>2</sup>	

**Load Characteristics 200 V, 60 Hz, 25 HP**

<b>% of Rated Load</b>	<b>25</b>	<b>50</b>	<b>75</b>	<b>100</b>	<b>125</b>	<b>150</b>	<b>S.F.</b>
<b>Power Factor</b>	48	71	80	84	85	85	85
<b>Efficiency</b>	85.9	90.6	91.7	91.7	91.2	90.4	91.4
<b>Speed</b>	1792	1784	1776	1767	1757	1746	1761
<b>Line amperes</b>	33	42	55	70	86	103	79.6

Performance Graph at 200V, 60Hz, 25.0HP Typical performance - Not guaranteed values

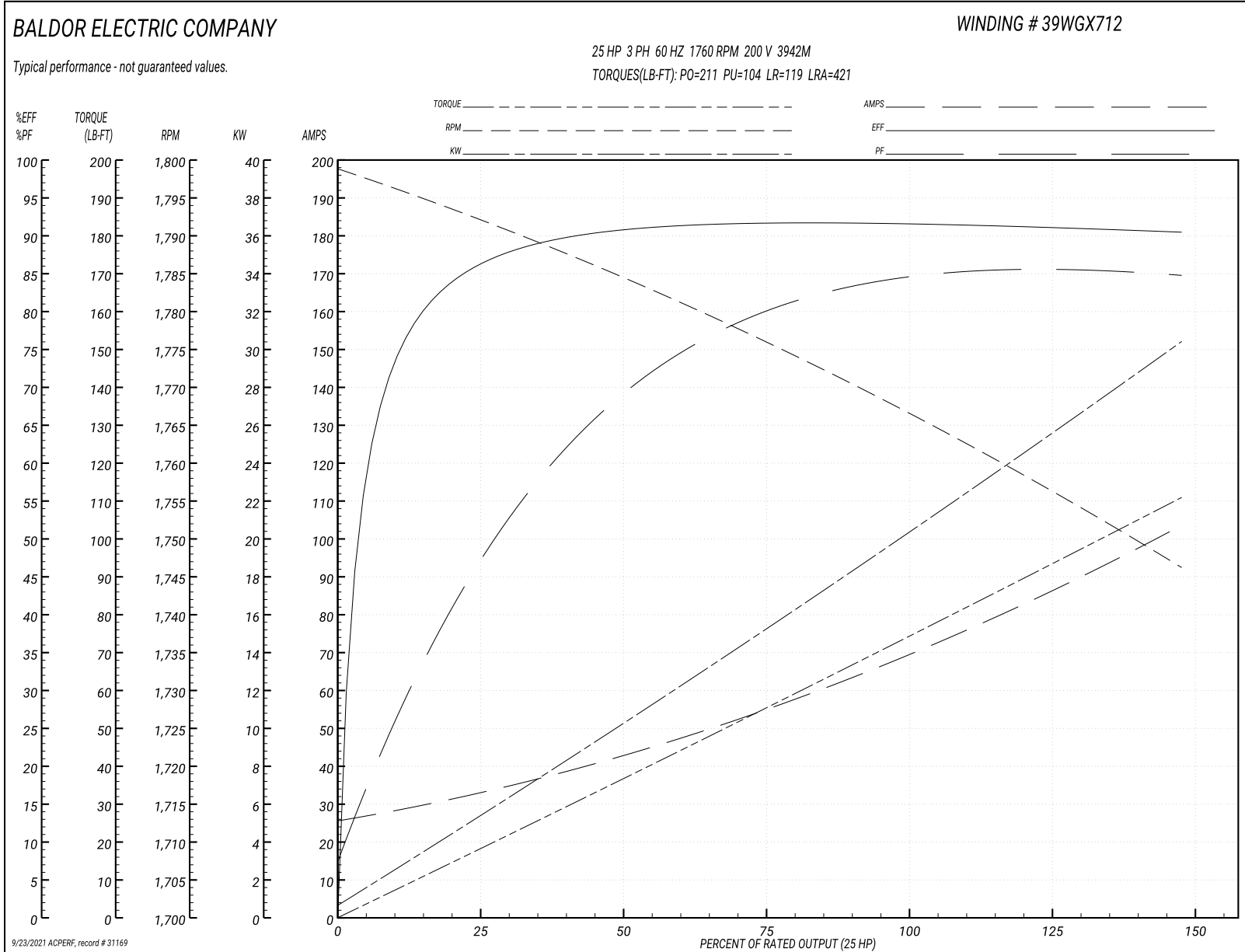

39LYL031

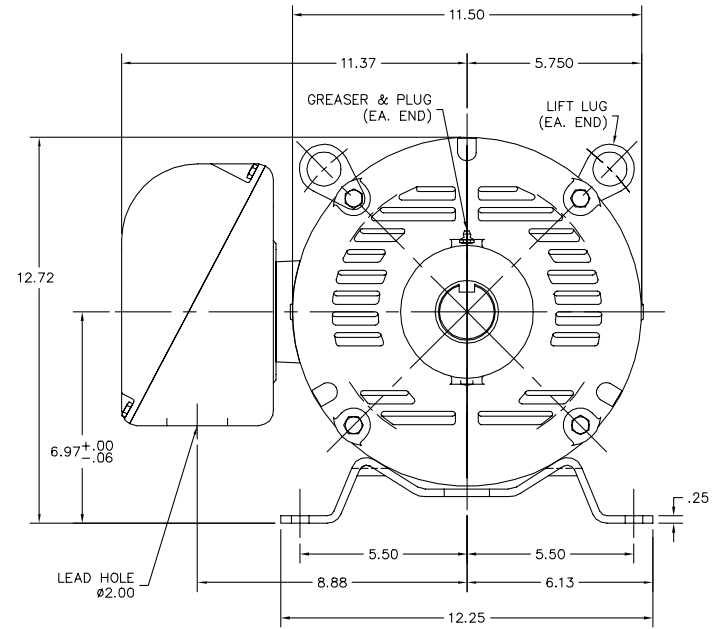
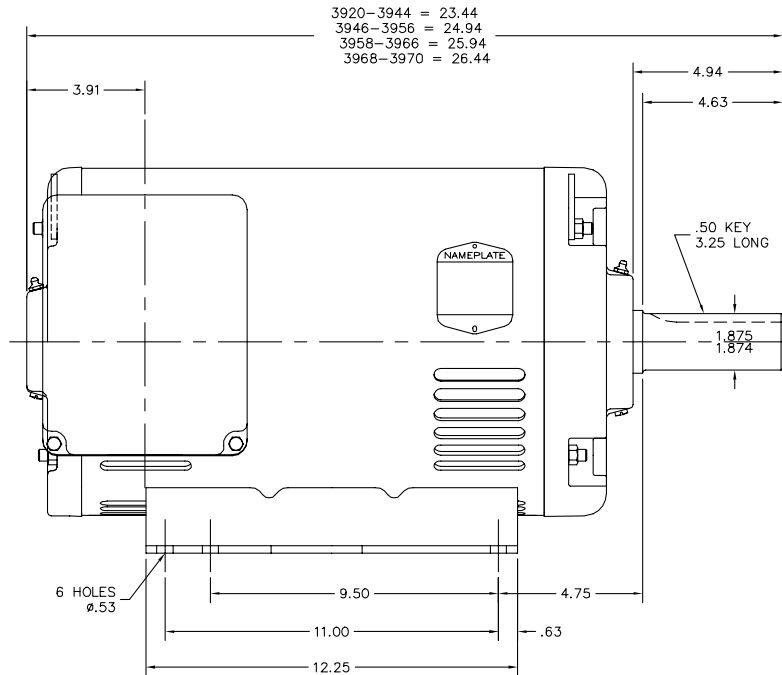

39LYL031

CUSTOMER IS RESPONSIBLE FOR DETERMINING THAT BALDOR'S PRODUCT WILL PERFORM SUITABLY IN THE INTENDED APPLICATION.

REV. DESC: ADDED MISSING DIMENSION		
REV. LTR: G	VERSION: 02	TDR: 000000858528
FILE: \AAA\00006\935	REVISED: 03:09:28 06/17/2014	BY: ENNINDO
MTL: -		

**BALDOR**

HOR OPSB - 284-6T  
 SH 1 of 1

CD0695

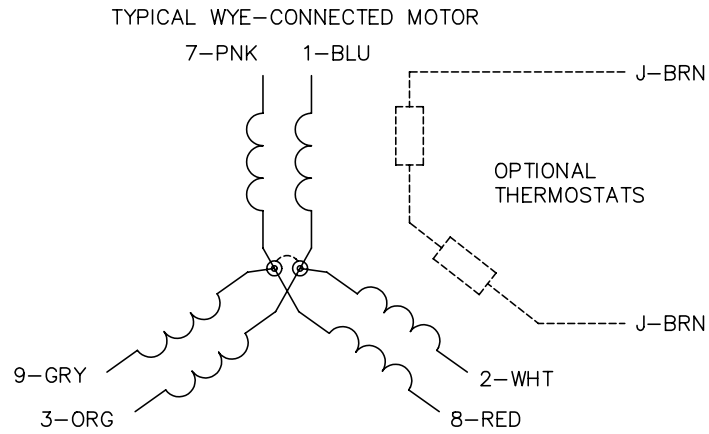

START CONNECTION

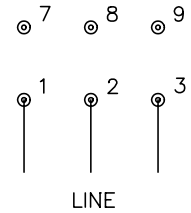

RUN CONNECTION

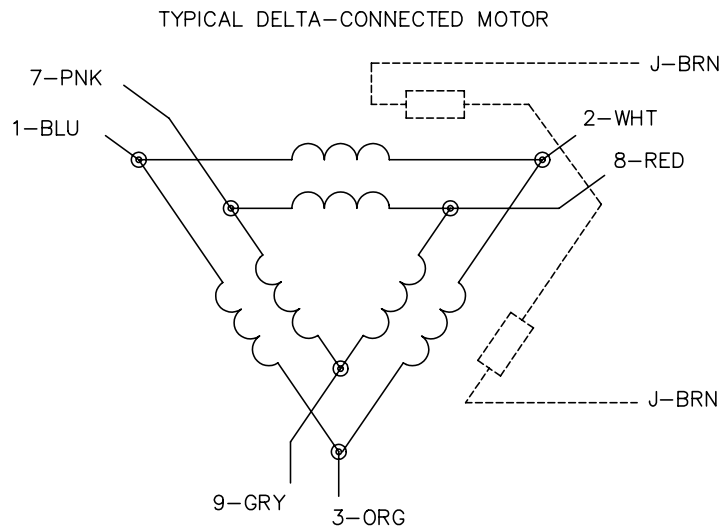
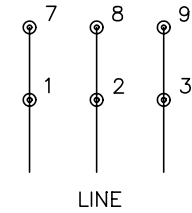

NOTES:

1. MOTOR MAY BE WYE CONNECTED OR DELTA CONNECTED.
2. INTERCHANGE ANY TWO LINE LEADS TO REVERSE ROTATION.
3. OPTIONAL THERMOSTATS ARE PROVIDED WHEN SPECIFIED.
4. ACTUAL NUMBER OF INTERNAL PARALLEL CIRCUITS MAY VARY.
5. LEAD COLORS ARE OPTIONAL. LEADS MUST ALWAYS BE NUMBERED AS SHOWN.

REV. DESC: REVISE TO SHOW OPTIONAL COLORS			
REV. LTR: C	BY: JLP	REVISED: 01/21/99 3:19	TDR: 0171435
9690D0		FILE: AAA00005151	MDL: -
		MTL: -	

**BALDOR ELECTRIC Co.**

3PH, SV, 6 LEADS, PART WINDING START

CD0695